

PREPARED FOR
PEDRO SEGURA
3735 W. BELMONT AVE.
CHICAGO IL. 60618

KROTT SURVEYING INC.
N3705 WILLOW BEND LANE
LAKE GENEVA WI. 53147
PHONE # (262)248-3697
FAX # (262)249-0639

PLAT OF SURVEY

- OF -

WETLANDS "A"

A PARCEL OF LAND BEING PART OF OUTLOT 1 OF WILLOW BEND PARK SUBDIVISION A SUBDIVISION LOCATED IN THE SOUTHWEST 1/4 AND THE SOUTHEAST 1/4 OF SECTION 15 AND THE NORTHWEST 1/4 AND THE NORTHEAST 1/4 OF SECTION 22, TOWN 2 NORTH, RANGE 17 EAST, WALWORTH COUNTY, WISCONSIN. MORE PARTICULARLY DESCRIBED AS FOLLOWS TO-WIT: COMMENCING AT THE SOUTHWEST CORNER OF THE SOUTHEAST 1/4 OF SAID SECTION 15; THENCE S 89°11'12" E ALONG THE SOUTH LINE OF SAID SECTION 15, 507.23 FEET; THENCE N 0°48'48" E 120.53 FEET; THENCE N 3°38'56" E 42.58 FEET TO THE POINT OF BEGINNING; THENCE N 17°22'17" W 56.56 FEET; THENCE N 17°36'29" W 38.53 FEET; THENCE N 22°15'19" W, 45.30 FEET; THENCE N 43°12'12" W, 29.59 FEET; THENCE N 41°09'33" W, 7.53 FEET; THENCE N 03°28'42" E, 45.51 FEET; THENCE N 87°56'35" E, 9.68 FEET; THENCE S 61°13'42" E, 24.56 FEET; THENCE S 32°05'25" E, 16.65 FEET; THENCE S 28°32'20" E, 25.10 FEET; THENCE S 32°05'25" E, 28.74 FEET; THENCE S 30°23'55" E, 43.57 FEET; THENCE S 1°28'58" E, 27.68 FEET; THENCE S 60°13'24" E, 12.83 FEET; THENCE S 1°50'47" E, 38.40 FEET; THENCE S 44°49'46" W, 21.27 FEET; THENCE S 66°56'49" W, 20.98 FEET TO THE POINT OF BEGINNING; SAID PARCEL OF LAND CONTAINING 8,834 SQUARE FEET MORE OR LESS.

WETLANDS "B"

A PARCEL OF LAND BEING PART OF OUTLOT 1 OF WILLOW BEND PARK SUBDIVISION A SUBDIVISION LOCATED IN THE SOUTHWEST 1/4 AND THE SOUTHEAST 1/4 OF SECTION 15 AND THE NORTHWEST 1/4 AND THE NORTHEAST 1/4 OF SECTION 22, TOWN 2 NORTH, RANGE 17 EAST, WALWORTH COUNTY, WISCONSIN. MORE PARTICULARLY DESCRIBED AS FOLLOWS TO-WIT: COMMENCING AT THE SOUTHWEST CORNER OF THE SOUTHEAST 1/4 OF SAID SECTION 15; THENCE S 89°11'12" E ALONG THE SOUTH LINE OF SAID SECTION 15, 507.23 FEET; THENCE N 0°48'48" E 120.53 FEET; THENCE N 58°44'14" E, 305.51 FEET; THENCE N 39°21'39" W, 205.27 FEET; THENCE S 56°04'43" W, 75.83 FEET TO THE POINT OF BEGINNING; THENCE S 61°34'32" E, 32.49 FEET; THENCE S 47°17'44" E, 45.10 FEET; THENCE S 27°33'50" E, 34.45 FEET; THENCE S 28°10'26" W, 35.79 FEET; THENCE N 70°37'58" W, 44.31 FEET; THENCE N 79°54'32" W, 39.49 FEET; THENCE N 43°55'15" W, 27.99 FEET; THENCE N 16°45'56" W, 47.46 FEET; THENCE N 25°17'54" E, 16.19 FEET; THENCE N 82°14'48" E, 46.54 FEET TO THE POINT OF BEGINNING. SAID PARCEL OF LAND CONTAINING 8,897 SQUARE FEET MORE OR LESS.

WETLANDS "C"

A PARCEL OF LAND BEING PART OF OUTLOT 1 OF WILLOW BEND PARK SUBDIVISION A SUBDIVISION LOCATED IN THE SOUTHWEST 1/4 AND THE SOUTHEAST 1/4 OF SECTION 15 AND THE NORTHWEST 1/4 AND THE NORTHEAST 1/4 OF SECTION 22, TOWN 2 NORTH, RANGE 17 EAST, WALWORTH COUNTY, WISCONSIN. MORE PARTICULARLY DESCRIBED AS FOLLOWS TO-WIT: COMMENCING AT THE SOUTHWEST CORNER OF THE SOUTHEAST 1/4 OF SAID SECTION 15; THENCE S 89°11'12" E ALONG THE SOUTH LINE OF SAID SECTION 15, 507.23 FEET; THENCE N 0°48'48" E 120.53 FEET; THENCE N 58°44'14" E 215.51 FEET TO THE POINT OF BEGINNING; THENCE N 25°12'01" W 16.61 FEET; THENCE N 44°45'44" W 25.61 FEET; THENCE N 41°19'48" E 19.97 FEET; THENCE N 29°26'50" E 30.30 FEET; THENCE N 19°24'10" W 20.20 FEET; THENCE N 6°36'04" W 14.30 FEET; THENCE N 27°37'54" W 24.86 FEET; THENCE N 41°15'13" W 30.71 FEET; THENCE N 34°05'05" W 30.34 FEET; THENCE N 34°04'02" E 15.44 FEET; THENCE N 28°03'03" W 16.47 FEET; THENCE S 39°21'39" E 205.27 FEET; THENCE S 58°44'14" W 90.00 FEET TO THE PLACE OF BEGINNING. SAID PARCEL OF LAND CONTAINING 7,861 SQUARE FEET, MORE OR LESS.

WETLANDS "D"

A PARCEL OF LAND BEING PART OF OUTLOT 1 OF WILLOW BEND PARK SUBDIVISION A SUBDIVISION LOCATED IN THE SOUTHWEST 1/4 AND THE SOUTHEAST 1/4 OF SECTION 15 AND THE NORTHWEST 1/4 AND THE NORTHEAST 1/4 OF SECTION 22, TOWN 2 NORTH, RANGE 17 EAST, WALWORTH COUNTY, WISCONSIN. MORE PARTICULARLY DESCRIBED AS FOLLOWS TO-WIT: COMMENCING AT THE SOUTHWEST CORNER OF THE SOUTHEAST 1/4 OF SAID SECTION 15; THENCE S 89°11'12" E ALONG THE SOUTH LINE OF SAID SECTION 15, 507.23 FEET; THENCE N 0°48'48" E 120.53 FEET; THENCE N 58°44'14" E 215.51 FEET TO THE POINT OF BEGINNING; THENCE N 25°12'01" W 16.61 FEET; THENCE N 44°45'44" W 25.61 FEET; THENCE N 41°19'48" E 19.97 FEET; THENCE N 29°26'50" E 30.30 FEET; THENCE N 19°24'10" W 20.20 FEET; THENCE N 6°36'04" W 14.30 FEET; THENCE N 27°37'54" W 24.86 FEET; THENCE N 41°15'13" W 30.71 FEET; THENCE N 34°05'05" W 30.34 FEET; THENCE N 34°04'02" E 15.44 FEET; THENCE N 28°03'03" W 16.47 FEET; THENCE S 39°21'39" E 205.27 FEET; THENCE S 58°44'14" W 90.00 FEET TO THE PLACE OF BEGINNING. SAID PARCEL OF LAND CONTAINING 656 SQUARE FEET MORE OR LESS.

LINE TABLE

WETLANDS "A" & "D"

| Id | Bearing | Distance |
|-----|---------------|----------|
| L1 | N 17°22'17" W | 56.56 |
| L2 | N 17°36'29" W | 38.53 |
| L3 | N 22°15'19" W | 45.30 |
| L4 | N 43°12'12" W | 29.59 |
| L5 | N 41°09'33" W | 37.08 |
| L6 | N 14°20'15" E | 23.31 |
| L7 | N 87°56'35" E | 26.13 |
| L8 | S 61°13'42" E | 24.56 |
| L9 | S 32°05'25" E | 16.65 |
| L10 | S 28°32'20" E | 25.10 |
| L11 | S 32°05'25" E | 28.74 |
| L12 | S 30°23'55" E | 43.57 |
| L13 | S 1°28'58" E | 27.68 |
| L14 | S 60°13'24" E | 12.83 |
| L15 | S 1°50'47" E | 38.40 |
| L16 | S 44°49'46" W | 21.27 |
| L17 | S 66°56'49" W | 20.98 |

WETLANDS "B"

| Id | Bearing | Distance |
|-----|---------------|----------|
| L18 | S 61°34'32" E | 32.49 |
| L19 | S 47°17'44" E | 45.10 |
| L20 | S 27°33'50" E | 34.45 |
| L21 | S 28°10'26" W | 35.79 |
| L22 | N 70°37'58" W | 44.31 |
| L23 | N 79°54'32" W | 39.49 |
| L24 | N 43°55'15" W | 27.99 |
| L25 | N 16°45'56" W | 47.46 |
| L26 | N 25°17'54" E | 16.19 |
| L27 | N 82°14'48" E | 46.54 |

WETLANDS "C"

| Id | Bearing | Distance |
|-----|---------------|----------|
| L28 | N 25°12'01" W | 16.61 |
| L29 | N 44°45'44" W | 25.61 |
| L30 | N 41°19'48" E | 19.97 |
| L31 | N 29°26'50" E | 30.30 |
| L32 | N 19°24'10" W | 20.20 |
| L33 | N 6°36'04" W | 14.30 |
| L34 | N 27°37'54" W | 24.86 |
| L35 | N 41°15'13" W | 30.71 |
| L36 | N 34°05'05" W | 30.34 |
| L37 | N 34°04'02" E | 15.44 |
| L38 | N 28°03'03" W | 16.47 |

LEGEND

○ FOUND IRON PIPE

■ SET IRON BAR

⊕ CONCRETE LID

(xx) RECORDED AS

TAX ID # [A104000000]

JOB # 08-138REZONE

NOTE: BEARINGS REFERENCED TO THE SOUTH LINE OF THE SOUTHEAST 1/4 OF SECTION 15-2-17
NOTE: BEARINGS HEREON RELATED TO GRID NORTH OF THE WISCONSIN STATE PLANE COORDINATE SYSTEM GRID, SOUTH ZONE (NAD-83)

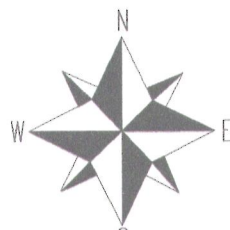

SCALE 1" = 60'

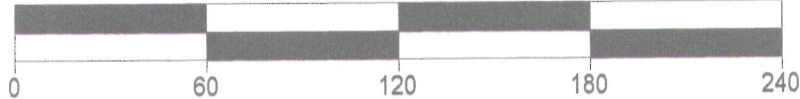

LOT 1 CERTIFIED SURVEY MAP NO. 1040

ZONED A-2

LOT 2

OUTLOT 1
WILLOW BEND PARK SUB.

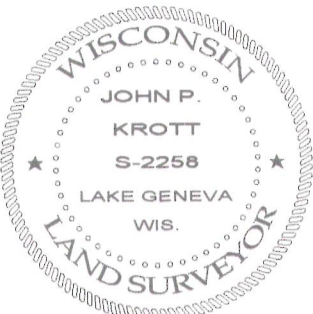

DATED THIS 31st DAY OF AUGUST 2012

John P. Krott

JOHN KROTT S - 2258
Wisconsin Registered Land Surveyor
(original if signed in red)

I have surveyed the above-described property and the above map is a true representation thereof and shows the size and location of the property, its exterior boundaries, the location and dimensions of all structures thereon, fences apparent easements and roadways and visible encroachments, if any.

This survey is made for the exclusive use of the present owners of the property, and also those who purchase, mortgage or insure the title thereto within one (1) year from date hereof; and as to them I warrant the accuracy of said survey map.

A PARCEL OF LAND BEING PART OF LOT 1 CERTIFIED SURVEY MAP NO. 1040 AND PART OF OUTLOT 1 OF WILLOWBEND PARK SUBDIVISION ALL LOCATED IN THE SOUTHEAST 1/4 OF THE SOUTHWEST 1/4 AND THE SOUTHWEST 1/4 OF THE SOUTHEAST 1/4 OF SECTION 15, ALL IN TOWN 2 NORTH, RANGE 17 EAST, WALWORTH COUNTY, WISCONSIN. MORE PARTICULARLY DESCRIBED AS FOLLOWS: COMMENCING AT THE SOUTHWEST CORNER OF THE SOUTHEAST 1/4 OF SAID SECTION 15; THENCE S 89°11'12" E ALONG THE SOUTH LINE OF THE SOUTHWEST 1/4 OF SAID SECTION 15, 507.23 FEET; THENCE N 0°48'48" E 120.53 FEET TO THE POINT OF BEGINNING; THENCE N 43°34'25" W 234.05 FEET TO A POINT IN THE SOUTH LINE OF LOT 1 OF SAID CERTIFIED SURVEY MAP NO. 1040; THENCE S 46°25'35" W ALONG SAID SOUTH LINE 150.00 FEET; THENCE S 77°23'17" W 393.13 FEET TO A POINT IN THE EASTERLY RIGHT-OF-WAY OF WILLOW BEND LANE; THENCE N 37°32'02" W ALONG SAID EASTERLY RIGHT-OF-WAY 455.22 FEET TO A POINT IN THE CENTERLINE OF SPRINGFIELD ROAD; THENCE N 52°30'45" E ALONG SAID CENTERLINE 360.98 FEET; THENCE S 37°16'41" E 49.96 FEET TO A POINT IN THE SOUTHERLY RIGHT-OF-WAY OF SPRINGFIELD ROAD; THENCE N 52°30'34" E ALONG SAID SOUTHERLY RIGHT-OF-WAY 447.07 FEET TO A POINT IN THE WESTERLY RIGHT-OF-WAY OF U.S.H. 12; THENCE S 39°21'39" E ALONG SAID WESTERLY RIGHT-OF-WAY 821.04 FEET; THENCE S 58°44'14" W 305.51 FEET TO THE PLACE OF BEGINNING. SAID PARCEL OF LAND CONTAINING 525,884 SQ. FT. MORE OR LESS.